

**REVERSIBLE VIBRATORY PLATES
BPR 70/70 D, BPR 100/80 D**

PERFORMANCE DATA



| Machine type | Compaction output (m3/h) at recommended soil layer thicknesses | | | |
|--------------|--|--------------|------------|------------|
| | Rock fill | Gravel, sand | Mixed soil | Silt, clay |
| BPR 70/70 D | 39-52 | 50-66 | 39-52 | 33-44 |
| BPR 100/80 D | 70-110 | 90-120 | 60-90 | 25-40 |

Technical Data

Shipping dimensions in m3

| | |
|---------------------|-------|
| BPR 70/70 D | 1,133 |
| BPR 100/80 D | 1,376 |

Standard Equipment

- Engine protection hood
- Electric starter
- Tip-Control
- Back-up drive protection
- Low vibration steering rod
- Height adjustable steering rod
- Steering rod lockable in transport and working position
- Vibration and throttle regulation on the steering rod
- Highly wear resistant base plate
- Automatic shutdown at low oil level
- Multi-functional, foldable single-point lifting facility
- Extension plates (700mm) (BPR70/70D)
- Extension plates (800mm) (BPR100/80D)
- 3-2-1 Warranty
- Hour meter

Optional Equipment

- ECONOMIZER (+5kg)
- Tool kit
- Special painting
- Plastic mat
- Extension plates (850mm) (BPR70/70D)
- Extension plates (950mm) (BPR100/80D)
- Service Kit
- Environmentally compliant hydraulic oil
- Safety crank-handle for emergency starting (+3kg)
- US Version EPA 4 NRTC (BPR70/70D:9,2kW; BPR100/80D:10,1kW)

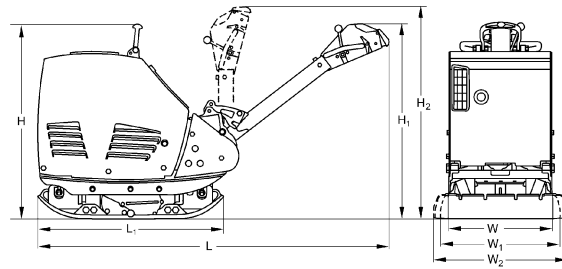

Dimensions in mm

| | H | H1 | H2 | L | L1 | W | W1 | W2 |
|---------------------|-----|------|------|------|-----|-----|-----|-----|
| BPR 70/70 D | 870 | 1030 | 1470 | 1860 | 980 | 550 | 700 | 850 |
| BPR 100/80 D | 910 | 1080 | 1470 | 1890 | 980 | 650 | 800 | 950 |

Technical Data

Weights

| | | | |
|----------------------------|----|-----|-----|
| Operating weight CECE (W) | kg | 557 | 687 |
| Operating weight CECE (W1) | kg | 580 | 710 |
| Operating weight CECE (W2) | kg | 595 | 726 |
| Basic weight | kg | 570 | 705 |

Dimensions

| | | | |
|--|----|-------|-------|
| Basic working width | mm | 700 | 800 |
| Working width without extension bars (W) | mm | 550 | 650 |
| Lowest passing height | mm | 870 | 910 |
| Min. height w. steering in top position | mm | 1.030 | 1.080 |
| Max. height w. steering in top position | mm | 1.180 | 1.180 |

Driving Characteristics

| | | | |
|---------------------------------------|-------|----|----|
| Working speed, max. | m/min | 28 | 28 |
| Max. gradeability (dep. on soil con.) | % | 35 | 35 |

Drive

| | | | |
|--------------------------------------|-------|---------|---------|
| Engine manufacturer | | Hatz | Hatz |
| Type | | 1D 81 | 1D 90 |
| Emission stage | | non EPA | non EPA |
| Cooling | | air | air |
| Number of cylinders | | 1 | 1 |
| Performance ISO 3046 | kW | 9,3 | 10,3 |
| Speed | min-1 | 2.700 | 2.600 |
| Drive system | | mech. | mech. |
| Fuel | | diesel | diesel |
| Fuel consump. aver. during operation | l/h | 2,0 | 2,2 |

Exciter system

| | | | |
|-------------------|----|------|------|
| Frequency | Hz | 66 | 56 |
| Centrifugal force | kN | 70 | 100 |
| Amplitude | mm | 1,80 | 2,70 |

Capacities

| | | | |
|------|---|------|------|
| Fuel | l | 10,0 | 10,0 |
|------|---|------|------|

Technical modifications reserved. Machines may be shown with options.

